



VACUUM TECHNOLOGY



TABLE OF CONTENTS

3	TOILET MODULE
7	URINAL MODULE
11	WASHBASIN MODULE
13	SHOWER MODULE 2.0
17	ADA MODULE
21	TECH MODULE
25	HOSE CRATE

TOILET MODULE | MAJOR ASSEMBLY

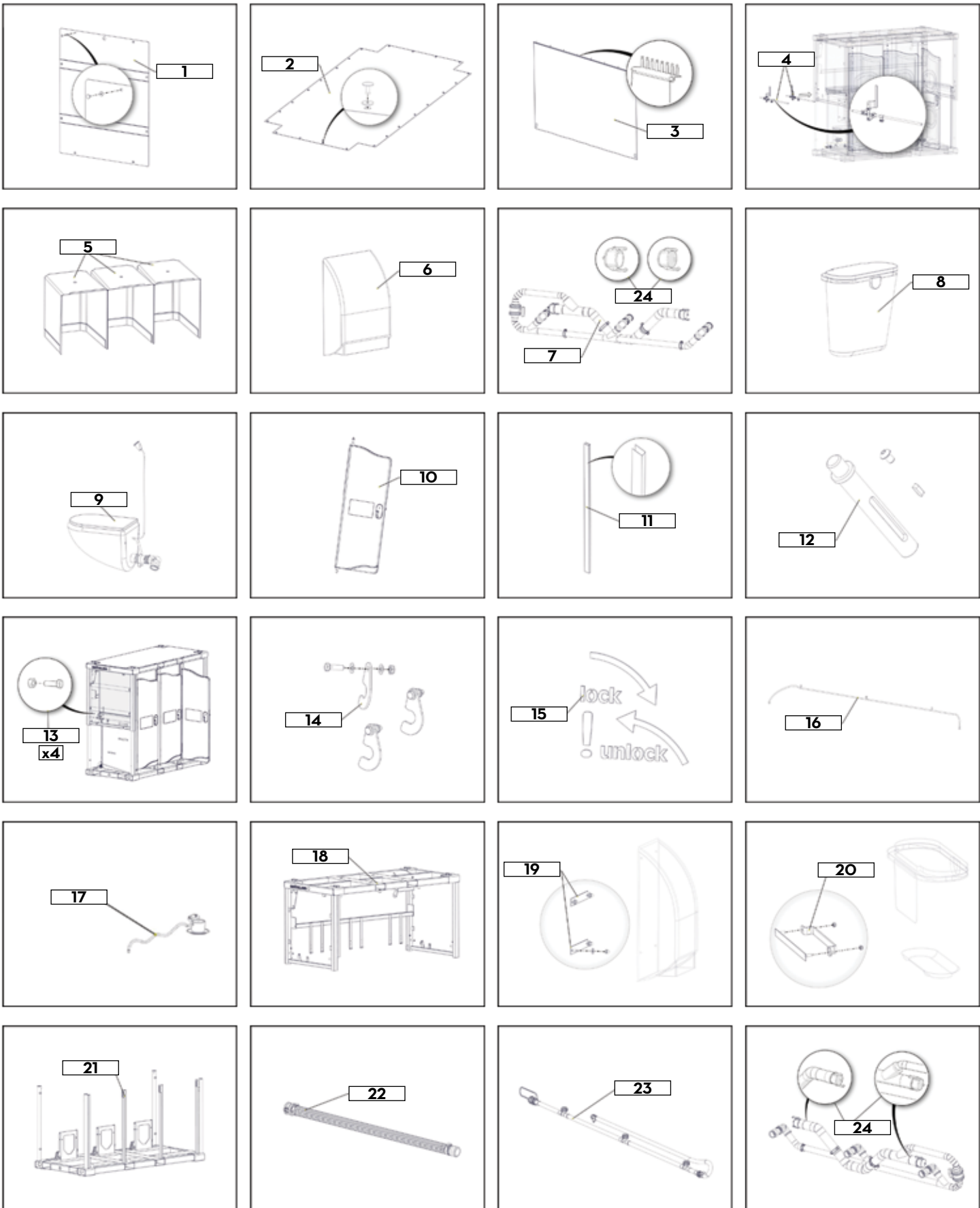

TOILET MODULE | MAJOR ASSEMBLY PARTS

ITEM #	PART #	QPU	DESCRIPTION	COMMENT
1	SAX-T3-001		SANITRAX- PLATE SIDE RAL 9010	
2	SAX-T3-002		SANITRAX- T3 ROOF PLATE W/RIVT	
3	SAX-T3-003		SANITRAX- T3 CURTAIN BACK W/AL	
4	SAX-T3-004		SANITRAX- T3 LOCKING MECHAN SS	
5	SAX-T3-005		SANITRAX- TOP INTERIOR RAL 9003	
6	SAX-T3-006		SANITRAX- T3 TOILET PAPER HOLD	
7	SAX-T3-007		SANITRAX- T3 PVC PIPING	
8	SAX-T3-008		SANITRAX- T3 WASTE BIN	
9	SAX-T3-009		TOILET JETS CHARM WALL	
10	SAX-T3-010		SANITRAX- T3 DOOR COMPLETE	
11	SAX-T3-011		SANITRAX- T3 PROFILE STAINLESS	
12	SAX-T3-012		SANITRAX- T3 DOOR UPPER PLUG	
13	SAX-T3-013		SANITRAX- T3 LOCKING BOLT/NUT	
14	SAX-T3-014		SANITRAX- T3 DOOR HOOK SET SS	
15	SAX-T3-015		SANITRAX- SICKER SET/LOCK/UNLK	
16	SAX-T3-016		SANITRAX- T3 WIRE ELECTRIC 12V	
17	SAX-T3-017		SANITRAX- T3 LED LIGHT	
18	SAX-T3-018		SANITRAX- T3 FRAME UPPER GALV	
19	SAX-T3-019		SANITRAX- T3 PAPER ROLL/HOLDER	
20	SAX-T3-020		SANITRAX- T3 MOUNT WASTE BIN	
21	SAX-T3-021		SANITRAX- T3 FRAME LOWER GALV	
22	SAX-T3-022		SANITRAX- T3 VAC HOSE (EDPM)	
23	SAX-T3-023		SANITRAX- T3 WATER PIPE SYS	
24	SAX-T3-024		SANITRAX- T3 KAMLOCK SETS	

TOILET MODULE | MAJOR ASSEMBLY (CONTINUED)

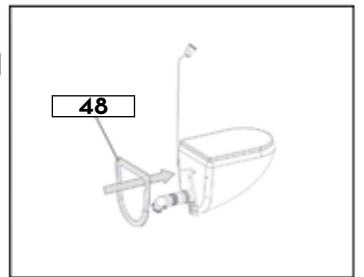
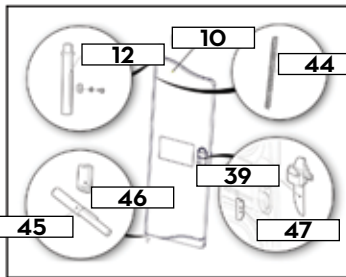
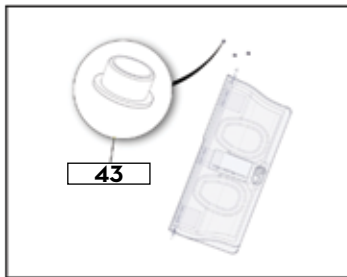
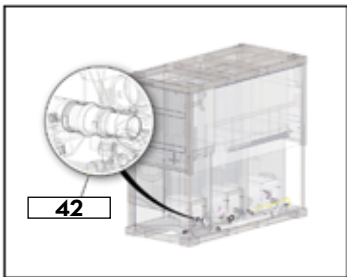
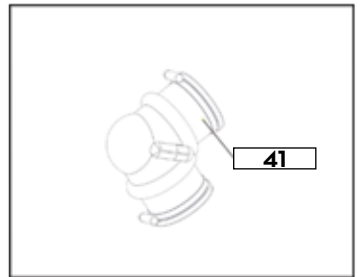
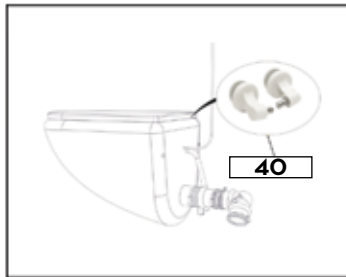
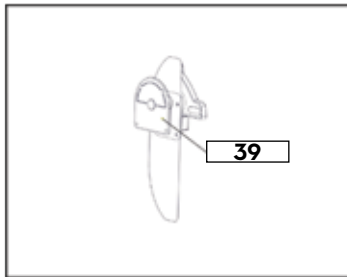
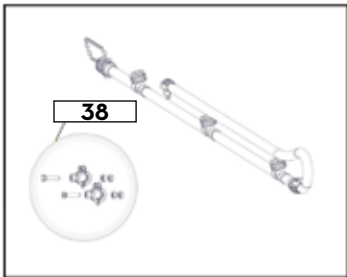
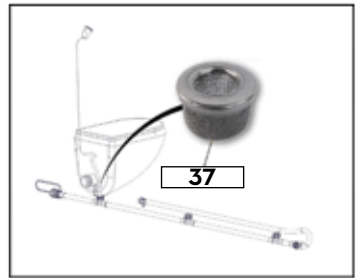
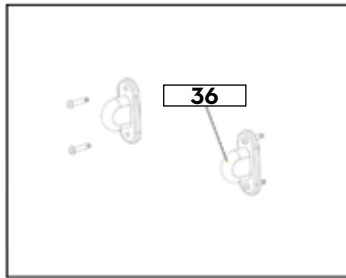
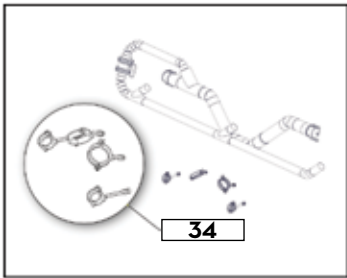
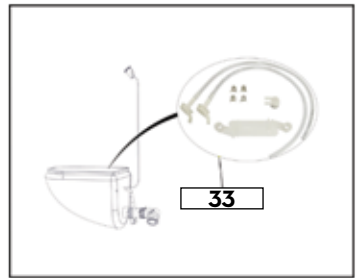
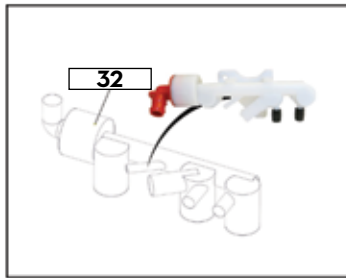
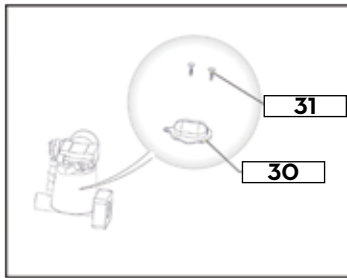
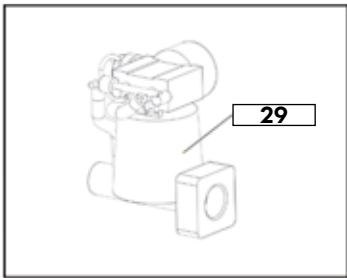
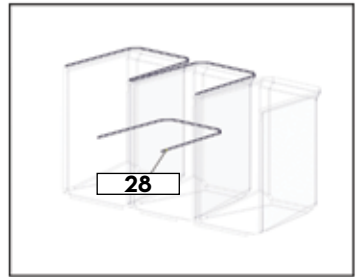
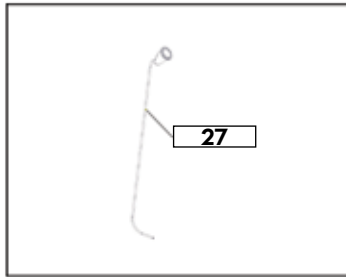
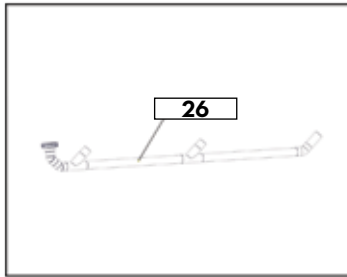
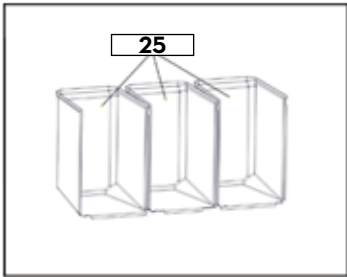

TOILET MODULE | MAJOR ASSEMBLY PARTS (CONTINUED)

ITEM #	PART #	QPU	DESCRIPTION	COMMENT
25	SAX-T3-025		SANITRAX- BOTOM INTER RAL 9004	
26	SAX-T3-026		SANITRAX- PIPE VAC SYS BOTTOM	
27	SAX-T3-027		SANITRAX- T3 FLUSH BUTTON W/Hs	
28	SAX-T3-028		SANITRAX- SILICON PROTECT PRO	
29	SAX-T3-029		SANITRAX- T3 VALVE TOILET	
30	SAX-T3-030		SANITRAX- T3 VALVE SHUT OFF	
31	SAX-T3-031		SANITRAX- VALVE MEMBRAN LIFTER	
32	SAX-T3-032		SANITRAX- T3 VALVE DISTRBUTOR	
33	SAX-T3-033		SANITRAX- T3 KIT FLUSH NOZZLE	
34	SAX-T3-034		SANITRAX- T3 CLAMP/BOLT VAC SY	
35	SAX-T3-035		SANITRAX- T3 TOILET SEAT VAN	
36	SAX-T3-036		SANITRAX- T3 CURTAIN LOCK STNL	
37	SAX-T3-037		SANITRAX- T3 FILTER VALVE TOIL	
38	SAX-T3-038		SANITRAX- T3 CLAMP/BOLT WATER	
39	SAX-T3-039		SANITRAX- LOCK DOORPARTS	
40	SAX-T3-040		SANITRAX- T3 FASTENING CHAR TS	
41	SAX-T3-041		SANITRAX- T3 RUBBER KINEE 50MM	
42	SAX-T3-042		SANITRAX- SLEVE RUBBER 50MM	
43	SAX-T3-043		SANITRAX- T3 DOOR BRONZ SET/3	
44	SAX-T3-044		SANITRAX- T3 DOOR PARTS SPRING	
45	SAX-T3-045		SANITRAX- PLUG DOOR BOTTM ALUM	
46	SAX-T3-046		SANITRAX- TURN DOOR BOTTM PLST	
47	SAX-T3-047		SANITRAX- T3 DOOR PART GRIP	
48	SAX-T3-048		SANITRAX- T3 TOILET COAMING	

URINAL MODULE | MAJOR ASSEMBLY

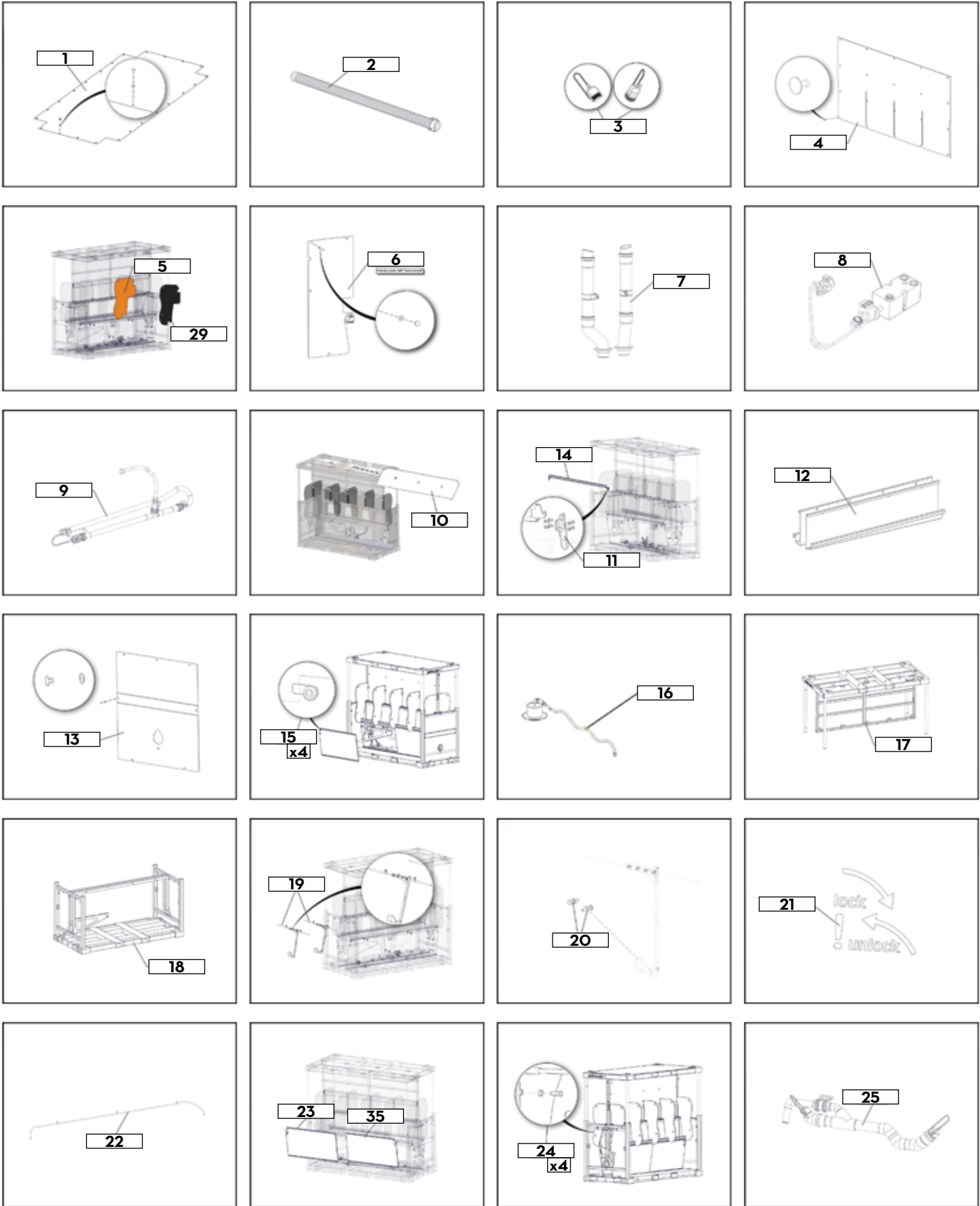

URINAL MODULE | MAJOR ASSEMBLY PARTS

ITEM #	PART #	QPU	DESCRIPTION	COMMENT
1	SAX-U8-001		SANITRAX- U8 PLATE RF RAL 9010	
2	SAX-U8-002		SANITRAX- U8 VAC HOSE 1600MX63	
3	SAX-U8-003		SANITRAX- U8 KAMLOCK SETS	
4	SAX-U8-004		SANITRAX- U8 PANEL RR HPL 9010	
5	SAX-U8-005		SANITRAX- U8 PRIVACY SHEET ORG	
6	SAX-U8-006		SANITRAX- U8 PLATE INTER LEFT	
7	SAX-U8-007		SANITRAX- U8 WASTE PIPE SET	
8	SAX-U8-008		GREY WATER INTERFACE UNIT 12L	
9	SAX-U8-009		SANITRAX- U8 WATER SYS COMP	
10	SAX-U8-010		SANITRAX- U8 ROOF INS RAL 9010	
11	SAX-U8-011		SANITRAX- U8 SAFETY CLAMP L/R	
12	SAX-U8-012		SANITRAX- U8 URINAL L/R STNLS	
13	SAX-U8-013		SANITRAX- U8 PLATE SIDE BLACK	
14	SAX-U8-014		SANITRAX- U8 PRIVACY SHEET L/B	
15	SAX-U8-015		SANITRAX- U8 DOOR LOCK SET/4	
16	SAX-U8-016		SANITRAX- U8 LIGHT LED W/WIRE	
17	SAX-U8-017		SANITRAX- U8 FRAME UPPER GALV	
18	SAX-U8-018		SANITRAX- U8 FRAME LOWER GALV	
19	SAX-U8-019		SANITRAX- U8 LOCK MECH L/R SS	
20	SAX-U8-020		SANITRAX- U8 SAFETY PIN L/R	
21	SAX-U8-021		SANITRAX- U8 STICKER LOCK/UNLK	
22	SAX-U8-022		SANITRAX- U8 WIRE ELECTRIC	
23	SAX-U8-023		SANITRAX- U8 INTER DOOR BLK L	
24	SAX-U8-024		SANITRAX- U8 BOLT/NUT SET/4	
25	SAX-U8-025		SANITRAX- U8 URINAL VAC SYS	

URINAL MODULE | MAJOR ASSEMBLY (CONTINUED)

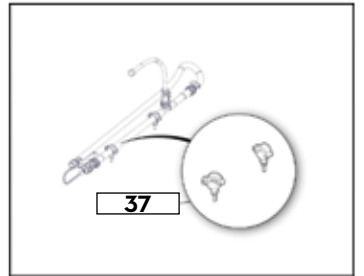
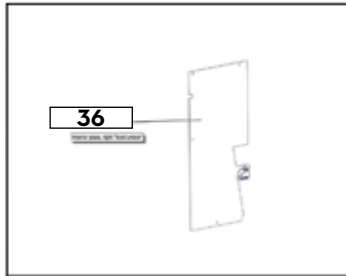
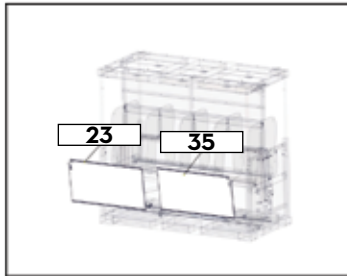
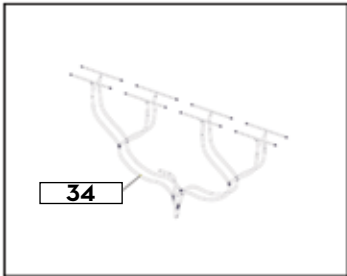
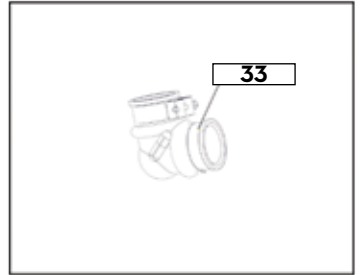
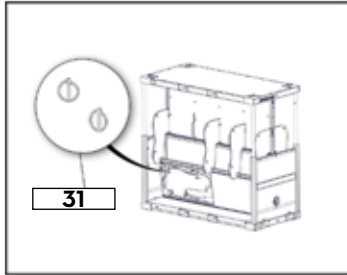
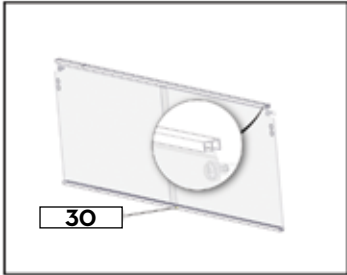
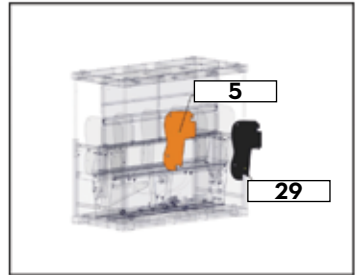
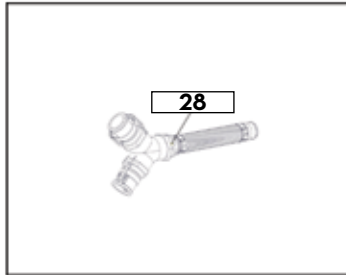
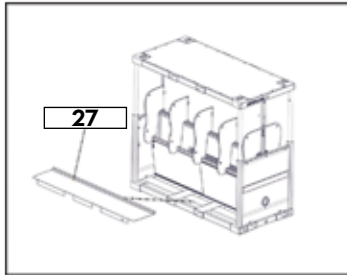
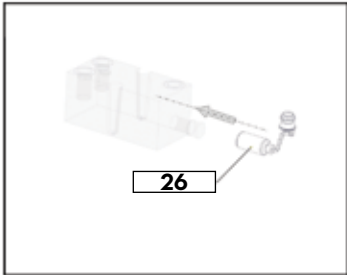

URINAL MODULE | MAJOR ASSEMBLY PARTS (CONTINUED)

ITEM #	PART #	QPU	DESCRIPTION	COMMENT
26	SAX-U8-026		SANITRAX- U8 SWITCH TANK LEVEL	
27	SAX-U8-027		SANITRAX- U8 PLATE FLOOR ALUM	
28	SAX-U8-028		SANITRAX- U8 HOSE URINAL CONN	
29	SAX-U8-029		SANITRAX- U8 PRIVACY SHEET BLK	
30	SAX-U8-030		SANITRAX- U8 RAIL DOOR SLIDE	
31	SAX-U8-031		SANITRAX- U8 LOCK PIN PRIV SHT	
32	SAX-U8-032		SANITRAX- U8 CLAMP/BOLT PIPE	
33	SAX-U8-033		SANITRAX- U8 KNEE RUBBER 50MM	
34	SAX-U8-034		SANITRAX- U8 FLUSH SYS WATER	
35	SAX-U8-035		SANITRAX- U8 INTER DOOR BLK R	
36	SAX-U8-036		SANITRAX- U8 PLATE INTER IN RT	
37	SAX-U8-037		SANITRAX- U8 CLAMP/BOLT PIP SY	

WASHBASIN MODULE | MAJOR ASSEMBLY

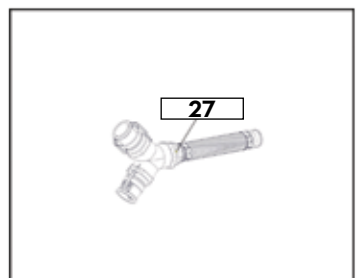
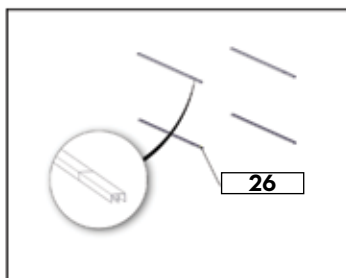
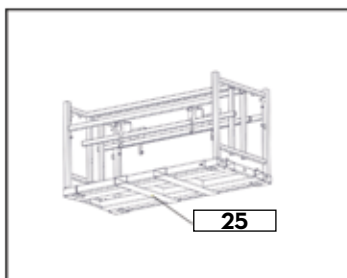
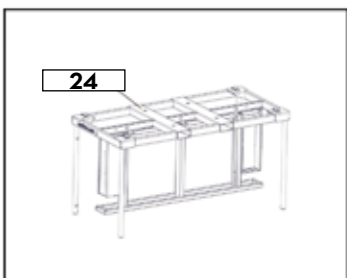
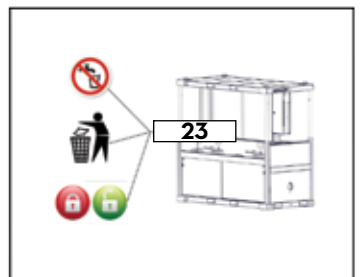
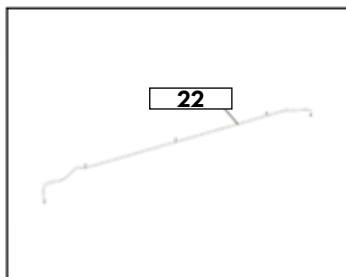
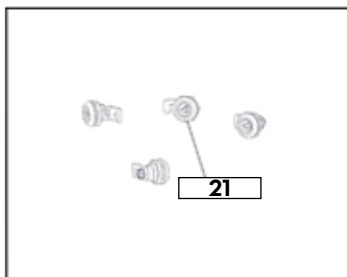
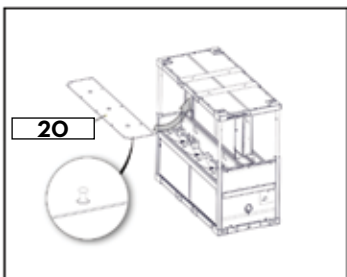
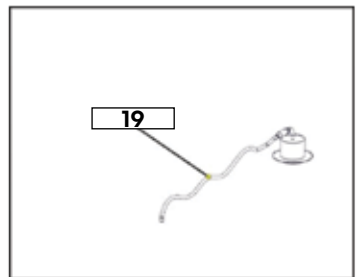
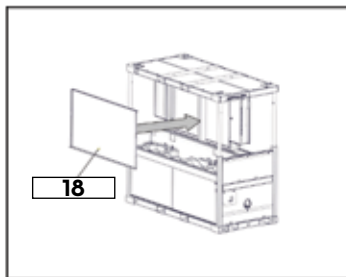
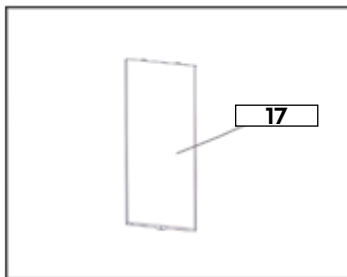
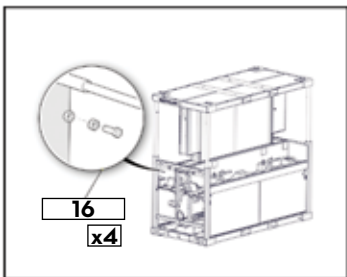
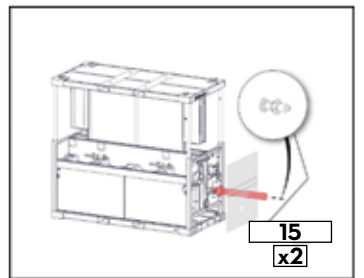
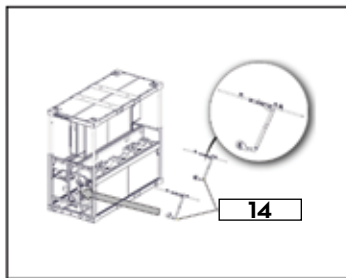
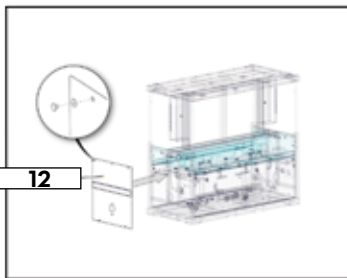
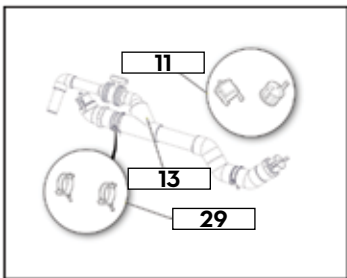
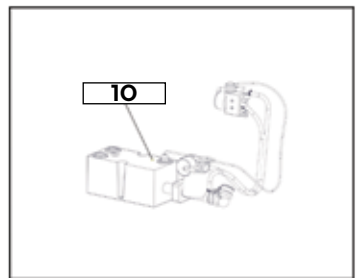
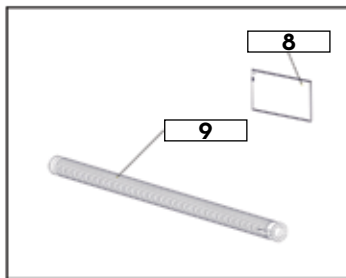
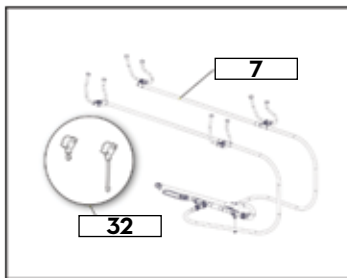
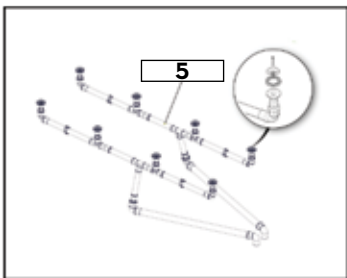
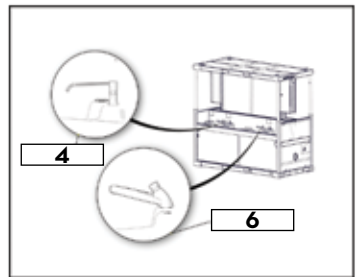
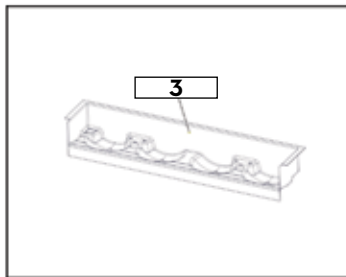
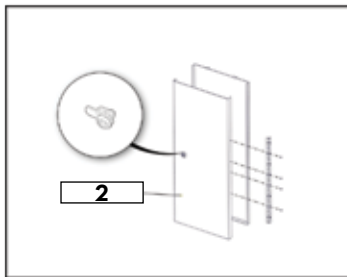
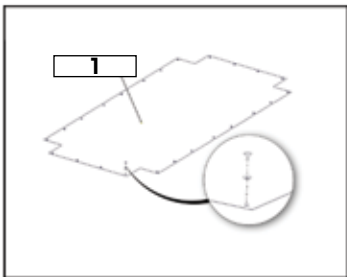

WASHBASIN MODULE | MAJOR ASSEMBLY (CONTINUED)

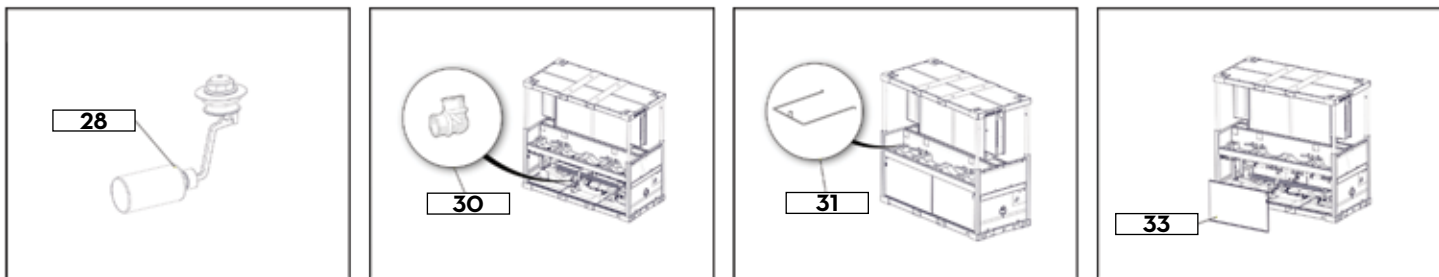

WASHBASIN MODULE | MAJOR ASSEMBLY PARTS

ITEM #	PART #	QPU	DESCRIPTION	COMMENT
1	SAX-W8-001		SANITRAX- W8 PLATE RF RAL 9010	
2	SAX-W8-002		SANITRAX- W8 PANEL MIRROW RGHT	
3	SAX-W8-003		SANITRAX- W8 WASHBASIN FIBERGL	
4	SAX-W8-004		SANITRAX- W8 SOAP DISPENSER	
5	SAX-W8-005		SANITRAX- W8 PIPE WASTE SET	
6	SAX-W8-006		SANITRAX- W8 WATER TAP	
7	SAX-W8-007		SANITRAX- W8 WATER SYS COMPLET	
8	SAX-W8-008		SANITRAX- W8 DOOR INTER BLCK	
9	SAX-W8-009		SANITRAX- W8 VAC HOSE 1.60MX63	
10	SAX-W8-010		GREY WATER INTERFACE UNIT 12L	
11	SAX-W8-011		SANITRAX- W8 KAMLOCK SETS	
12	SAX-W8-012		SANITRAX- W8 PLATE SIDE BLACK	
13	SAX-W8-013		SANITRAX- W8 VAC SYS PIPING	
14	SAX-W8-014		SANITRAX- W8 LOCKING MECH L/R	
15	SAX-W8-015		SANITRAX- W8 SAFETY PIN SY L/R	
16	SAX-W8-016		SANITRAX- W8 BOLT/NUT LOCK S/4	
17	SAX-W8-017		SANITRAX- W8 PANEL MIRROW LEFT	
18	SAX-W8-018		SANITRAX- W8 PANEL MIRROW MIDD	
19	SAX-W8-019		SANITRAX- W8 LIGHT LED W/WIRE	
20	SAX-W8-020		SANITRAX- W8 ROOF INS RAL 9010	
21	SAX-W8-021		SANITRAX- W8 DOOR LOCK SET/4	
22	SAX-W8-022		SANITRAX- W8 WIRE ELECTRIC	
23	SAX-W8-023		SANITRAX- W8 STICKER SET	
24	SAX-W8-024		SANITRAX- W8 FRAME LOWER GALV	
25	SAX-W8-025		SANITRAX- W8 FRAME UPPER GALV	
26	SAX-W8-026		SANITRAX- W8 RAIL DOOR SLIDING	
27	SAX-W8-027		SANITRAX- W8 WASHBASIN CONNECT	
28	SAX-W8-028		SANITRAX- W8 SWITCH LEVEL G/WR	
29	SAX-W8-029		SANITRAX- W8 CLAMP/BOLT WTR/PP	
30	SAX-W8-030		SANITRAX- W8 KNEE RUBBER 50MM	
31	SAX-W8-031		SANITRAX- W8 WASTE BAG HANG SY	
32	SAX-W8-032		SANITRAX- W8 CLAMP/BOLT PIPE S	
33	SAX-W8-033		SANITRAX- W8 DOOR INTER RIGHT	

SHOWER MODULE 2.0 | MAJOR ASSEMBLY

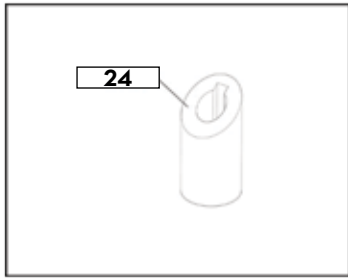
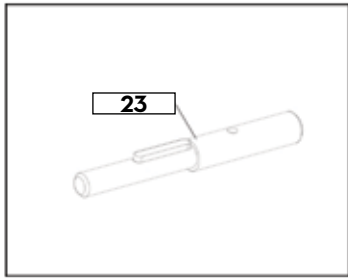
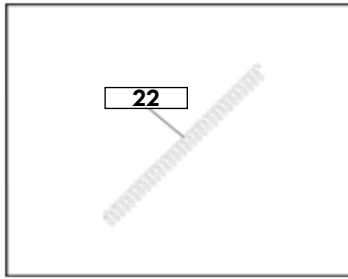
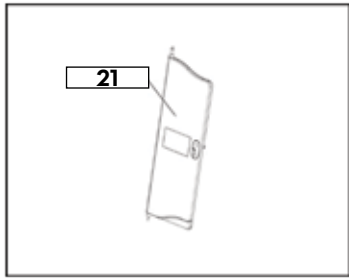
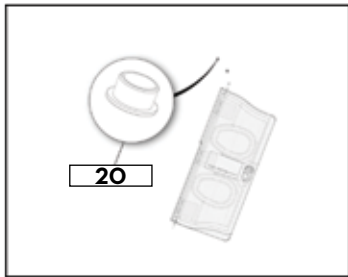
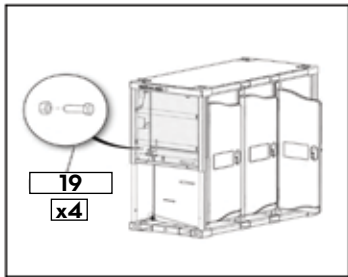
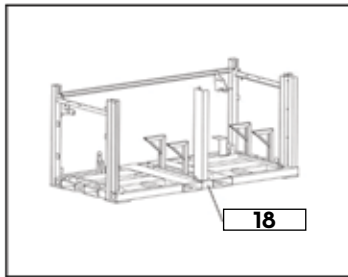
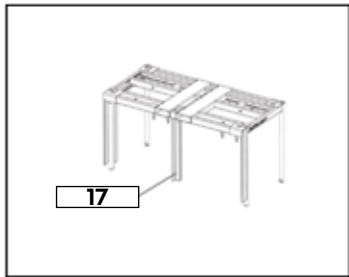
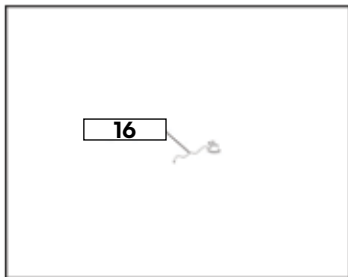
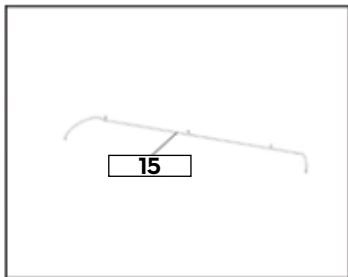
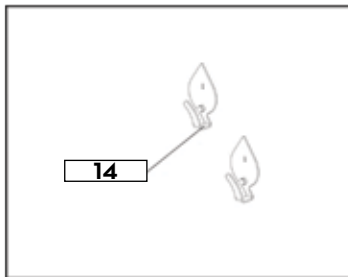
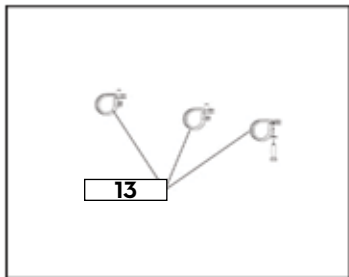
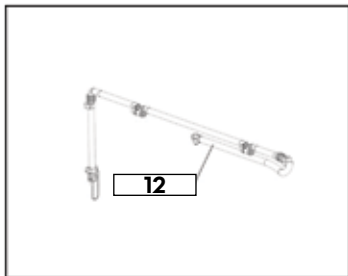
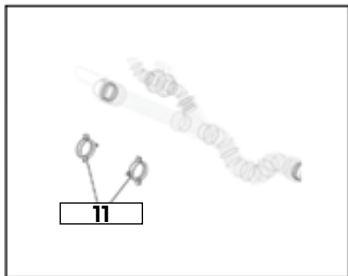
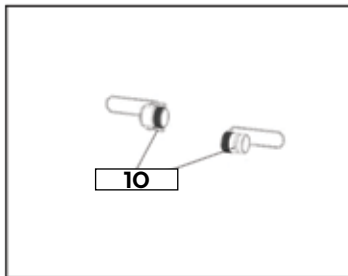
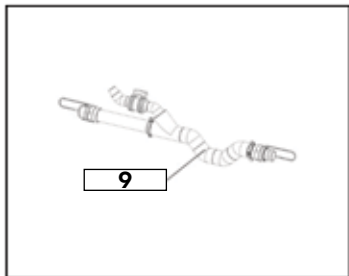
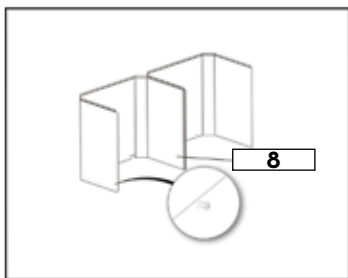
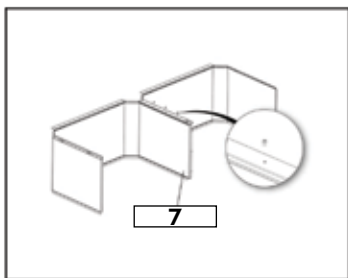
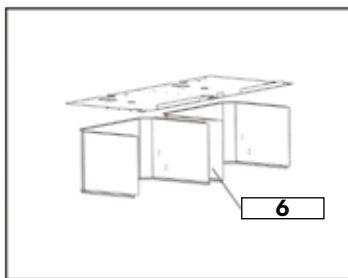
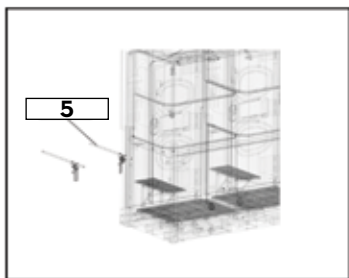
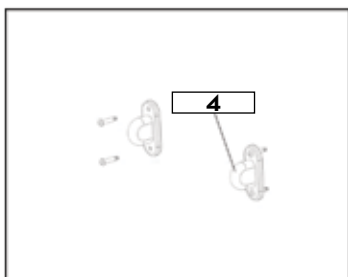
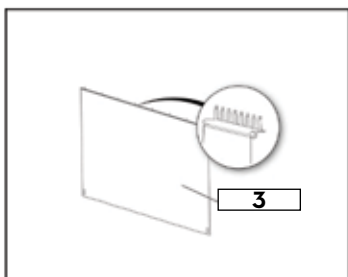
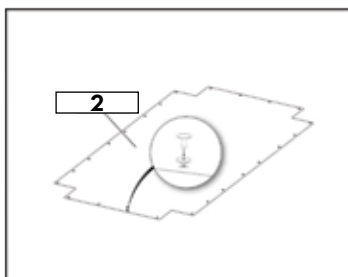
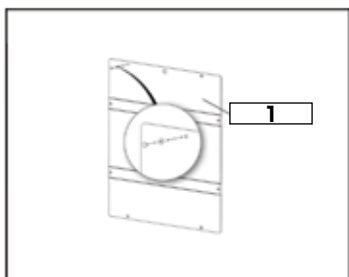

SHOWER MODULE 2.0 | MAJOR ASSEMBLY PARTS

ITEM #	PART #	QPU	DESCRIPTION	COMMENT
1	SAX-S2-2-0-001		SANITRAX- S2 PLATE SD RAL 9010	
2	SAX-S2-2-0-002		SANITRAX- S2 PLATE RF RAL 9010	
3	SAX-S2-2-0-003		SANITRAX- S2 CURTAIN BACK AL/P	
4	SAX-S2-2-0-004		SANITRAX- S2 CURTAIN LOCK ST/2	
5	SAX-S2-2-0-005		SANITRAX- S2 LOCK MECHA R/L SS	
6	SAX-S2-2-0-006		SANITRAX- S2 WALL TOP RL 9010	
7	SAX-S2-2-0-007		SANITRAX- S2 WALL MIDD RL 9010	
8	SAX-S2-2-0-008		SANITRAX- S2 WALL BOT T RL 7024	
9	SAX-S2-2-0-009		SANITRAX- S2 VAC SYS PVC W/CAM	
10	SAX-S2-2-0-010		SANITRAX- S2 CAMLOCK SET	
11	SAX-S2-2-0-011		SANITRAX- S2 CLAMP/BOLT VAC SY	
12	SAX-S2-2-0-012		SANITRAX- S2 WATER PIPING SYS	
13	SAX-S2-2-0-013		SANITRAX- S2 CLAMP/BOLT VAC SY	
14	SAX-S2-2-0-014		SANITRAX- S2 CLOTHHOOK SET/2	
15	SAX-S2-2-0-015		SANITRAX- S2 WIRE ELECTRIC 12V	
16	SAX-S2-2-0-016		SANITRAX- S2 LIGHT LED W/WIRE	
17	SAX-S2-2-0-017		SANITRAX- S2 FRAME UPPER GALV	
18	SAX-S2-2-0-018		SANITRAX- S2 FRAME LOWER GALV	
19	SAX-S2-2-0-019		SANITRAX- S2 BOLT/NUT SET/4	
20	SAX-S2-2-0-020		SANITRAX- S2 DOOR BUS BRO ST/2	
21	SAX-S2-2-0-021		SANITRAX- S2 DOOR COMPLETE	
22	SAX-S2-2-0-022		SANITRAX- S2 SPRING DOOR PART	
23	SAX-S2-2-0-023		SANITRAX- S2 PLUG DOOR PART AL	
24	SAX-S2-2-0-024		SANITRAX- S2 TURN DOORPART PLS	

SHOWER MODULE 2.0 | MAJOR ASSEMBLY (CONTINUED)

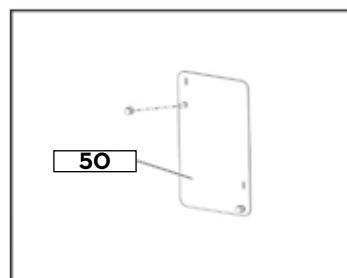
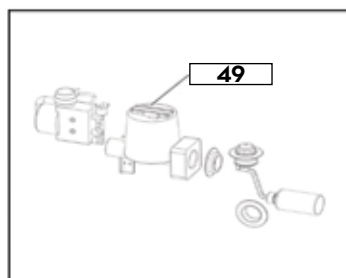
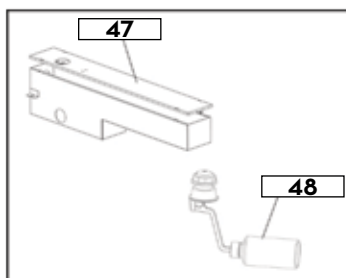
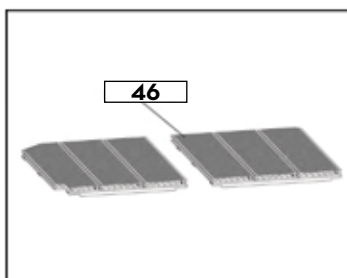
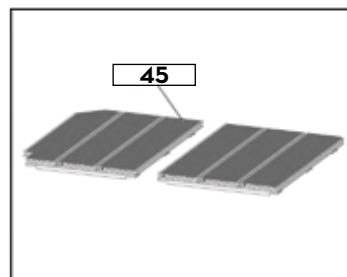
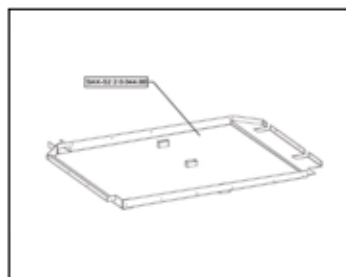
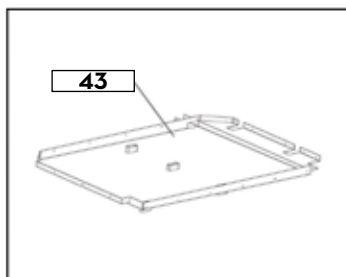
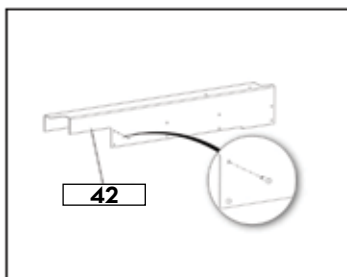
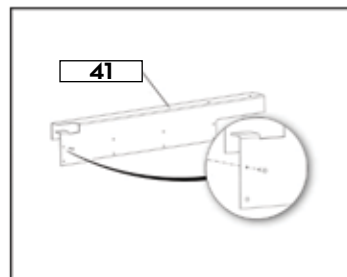
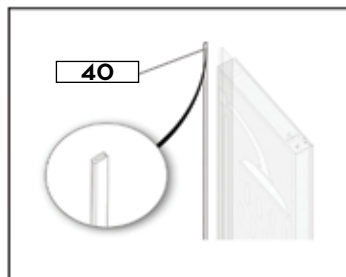
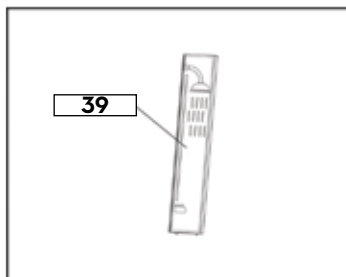
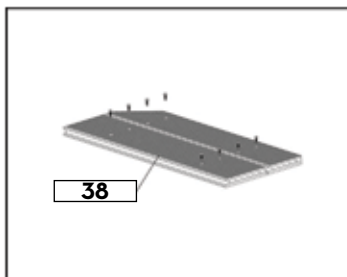
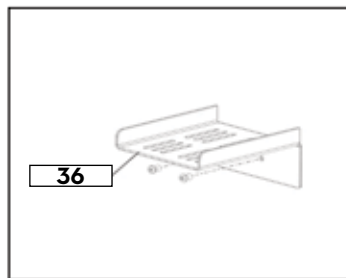
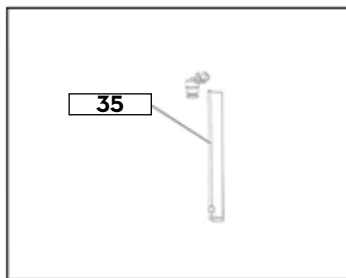
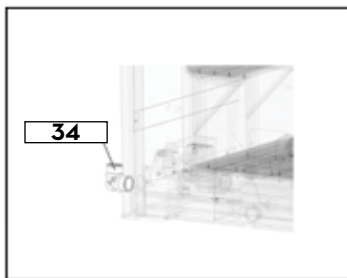
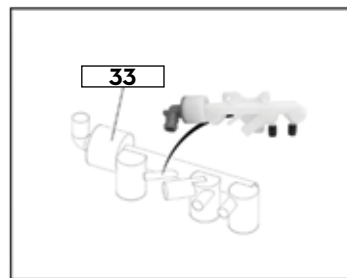
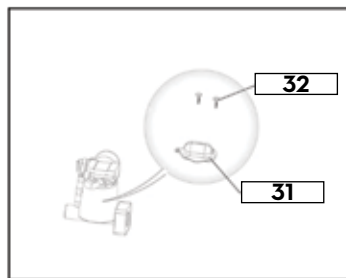
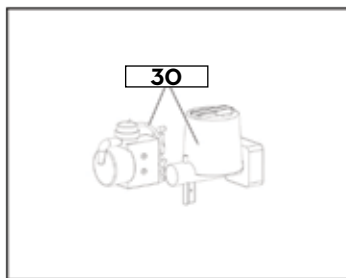
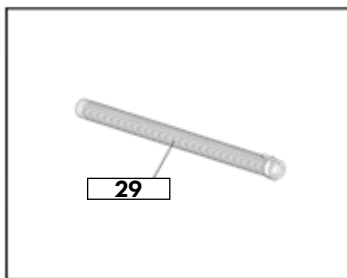
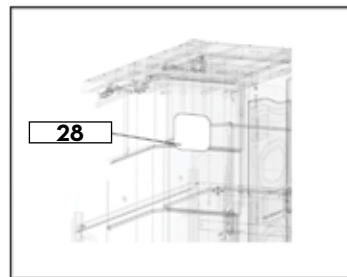
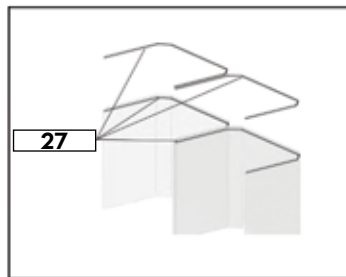
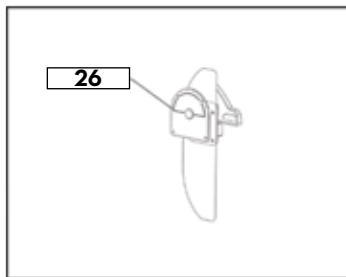
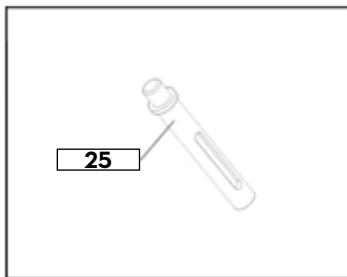

SHOWER MODULE 2.0 | MAJOR ASSEMBLY PARTS (CONTINUED)

ITEM #	PART #	QPU	DESCRIPTION	COMMENT
25	SAX-S2-2-0-025		SANITRAX- S2 TURN DOORPART TOP	
26	SAX-S2-2-0-026		SANITRAX- S2 LOCK DOORPART	
27	SAX-S2-2-0-027		SANITRAX- S2 SILICON PROT PROF	
28	SAX-S2-2-0-028		SANITRAX- S2 MIRROR	
29	SAX-S2-2-0-029		SANITRAX- S2 VACUUM HOSE	
30	SAX-S2-2-0-030		SANITRAX- S2 VALVE TOILET	
31	SAX-S2-2-0-031		SANITRAX- S2 VALVE TOILT SH/OF	
32	SAX-S2-2-0-032		SANITRAX- S2 VALVE TOILET LIFT	
33	SAX-S2-2-0-033		SANITRAX- S2 VALVE TOILET DIST	
34	SAX-S2-2-0-034		SANITRAX- KNEE RUBBER 50/50MM	
35	SAX-S2-2-0-035		SANITRAX- S2 PANEL SHOWER	
36	SAX-S2-2-0-036		SANITRAX- S2 SHELF SOAP SET/2	
37	SAX-S2-2-0-037		SANITRAX- S2 CURTAIN SHWR ST/2	
38	SAX-S2-2-0-038		SANITRAX- S2 PANEL SEAT	
39	SAX-S2-2-0-039		SANITRAX- S2 PANEL FRONT S/LOG	
40	SAX-S2-2-0-040		SANITRAX- S2 SILICON PROTECTIN	
41	SAX-S2-2-0-041		SANITRAX- S2 PANEL BOT LEFT AL	
42	SAX-S2-2-0-042		SANITRAX- S2 PANEL BOT RIGHT AL	
43	SAX-S2-2-0-043		SANITRAX- S2 FLOOR PART LEFT	
44	SAX-S2-2-0-044		SANITRAX- S2 FLOOR PART RIGHT	
45	SAX-S2-2-0-045		SANITRAX- S2 FLOOR PART LEFT	
46	SAX-S2-2-0-046		SANITRAX- S2 FLOOR PART RIGHT	
47	SAX-S2-2-0-047		SANITRAX- S2 WASTEWATER TANK	
48	SAX-S2-2-0-048		VALVE VAC W/SWTH	
49	SAX-S2-2-0-049		JETS VD VALVE PISTON	
50	SAX-S2-2-0-050		SANITRAX- S2 MOUNT COOK HOOK	

ADA MODULE | MAJOR ASSEMBLY



ADA MODULE | MAJOR ASSEMBLY PARTS

ITEM #	PART #	QPU	DESCRIPTION	COMMENT
1	SAX-AD-2-0-001		SANITRAX- AD FRAME GALVANIZED	
2	SAX-AD-2-0-002		SANITRAX- AD FLOOR PANEL	
3	SAX-AD-2-0-003		SANITRAX- AD FLOOR PNL BK LEFT	
4	SAX-AD-2-0-004		SANITRAX- AD FLOOR PNL FT LEFT	
5	SAX-AD-2-0-005		SANITRAX- AD FLOOR PNL BK RIGHT	
6	SAX-AD-2-0-006		SANITRAX- AD FLOOR PNL FT RIGHT	
7	SAX-AD-2-0-007		SANITRAX- AD WALL OUT/UPP LEFT	
8	SAX-AD-2-0-008		SANITRAX- AD WALL OUT/LOW LEFT	
9	SAX-AD-2-0-009		SANITRAX- AD WALL INSIDE LEFT	
10	SAX-AD-2-0-010		SANITRAX- AD WALL INSIDE BACK	
11	SAX-AD-2-0-011		SANITRAX- AD WALL RIGHT	
12	SAX-AD-2-0-012		SANITRAX- AD CEILING INNER	
13	SAX-AD-2-0-013		SANITRAX- AD WALL FRONT	
14	SAX-AD-2-0-014		SANITRAX- AD ROOF PLATE 9010	
15	SAX-AD-2-0-015		SANITRAX- AD DOOR PANEL W/PART	
16	SAX-AD-2-0-016		SANITRAX- AD DOOR LOCK SYSTEM	
17	SAX-AD-2-0-017		SANITRAX- AD DOOR LGHT LED G/R	
18	SAX-AD-2-0-018		SANITRAX- AD MOTION SENSOR W/C	
19	SAX-AD-2-0-019		SANITRAX- AD FRONT WINDOW	
20	SAX-AD-2-0-020		SANITRAX- AD SINK	
21	SAX-AD-2-0-021		SANITRAX- AD WATERTAP	
22	SAX-AD-2-0-022		SANITRAX- AD SHOWER	
23	SAX-AD-2-0-023		SANITRAX- AD SEAT SHOWER	
24	SAX-AD-2-0-024		SANITRAX- AD TOILET COMPLETE	
25	SAX-AD-2-0-025		SANITRAX- AD SEAT TOILET V/SAF	
26	SAX-AD-2-0-026		SANITRAX- AD FLUSH BUTTON W/Hs	
27	SAX-AD-2-0-027		SANITRAX- AD VALVE TOILET	
28	SAX-AD-2-0-028		SANITRAX- AD VALVE TOILET S/OF	
29	SAX-AD-2-0-029		SANITRAX- AD VALVE TOILET LIFT	
30	SAX-AD-2-0-030		SANITRAX- AD VALVE TOILET DIST	
31	SAX-AD-2-0-031		SANITRAX- AD NOZZLE KIT FLH	
32	SAX-AD-2-0-032		CALL FOR DETAILS	
33	SAX-AD-2-0-033		SANITRAX- AD BABY STATION	
34	SAX-AD-2-0-034		SANITRAX- AD MIRROR	
35	SAX-AD-2-0-035		SANITRAX- AD PANEL RIGHT V/GRP	
36	SAX-AD-2-0-036		SANITRAX- AD PANEL BACK GRIP	
37	SAX-AD-2-0-037		SANITRAX- AD PANEL RIGHT GRIP	
38	SAX-AD-2-0-038		SANITRAX- AD WIRE ELECT TRAF/D	
39	SAX-AD-2-0-039		SANITRAX- AD CONVERTR 110/230V	

ADA MODULE | MAJOR ASSEMBLY (CONTINUED)

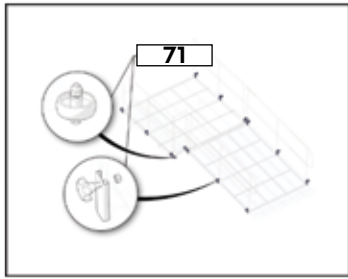
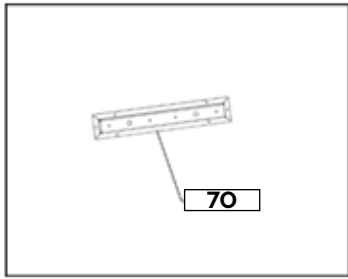
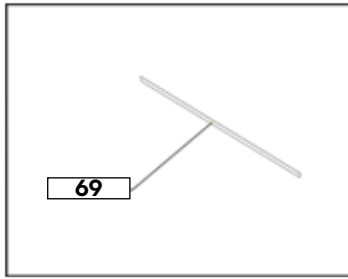
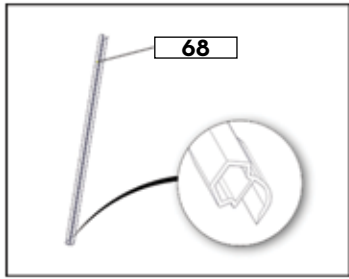
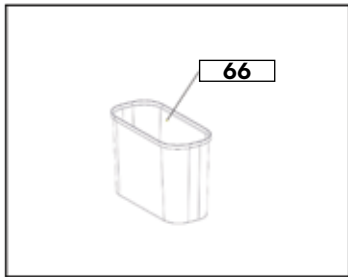
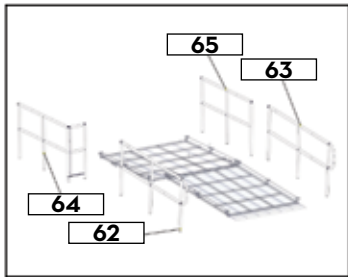
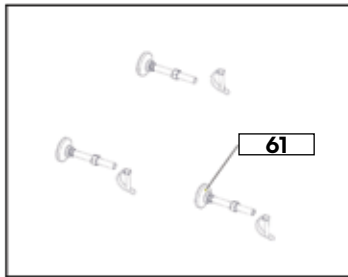
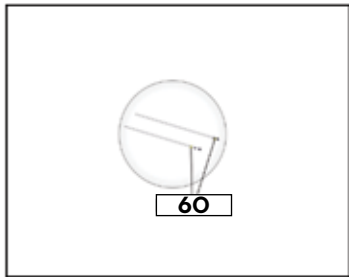
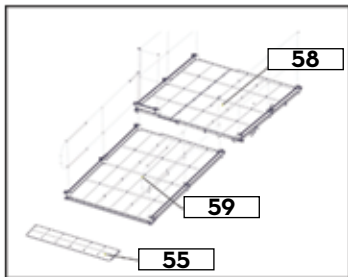
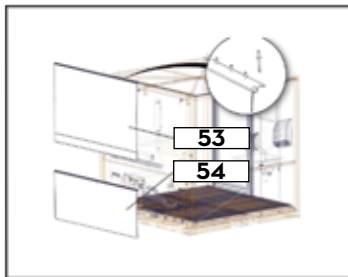
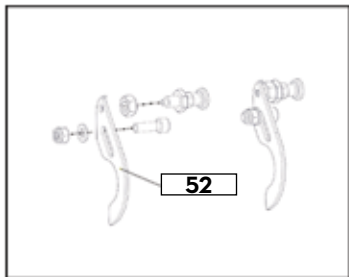
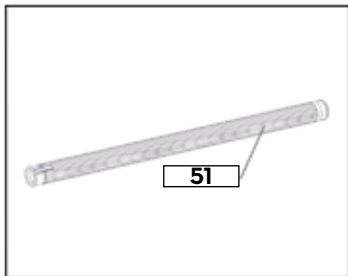
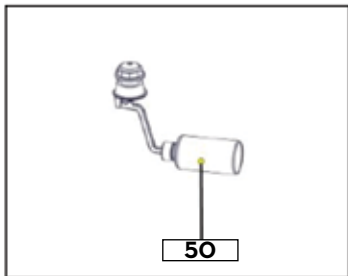
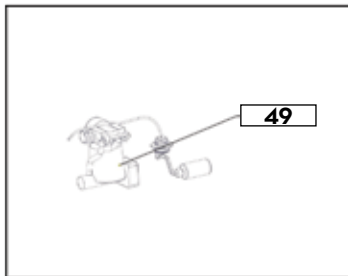
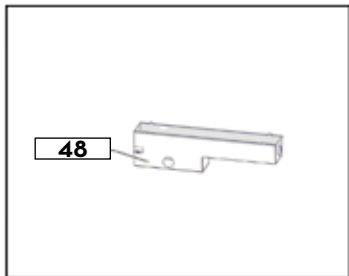
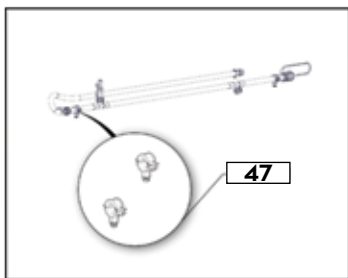
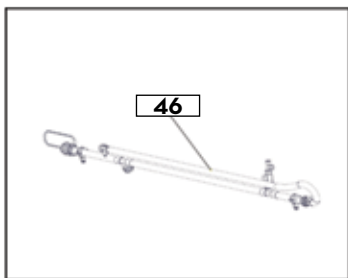
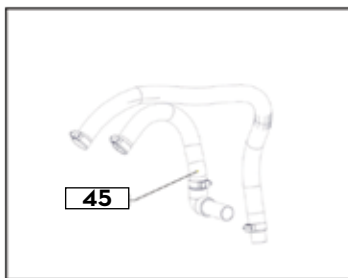
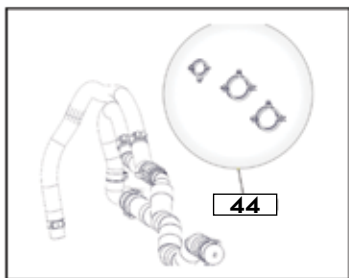
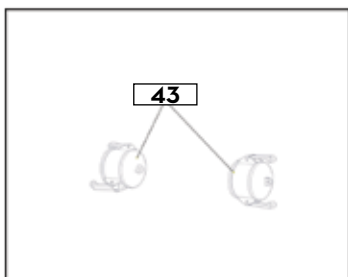
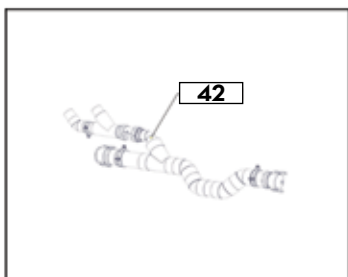
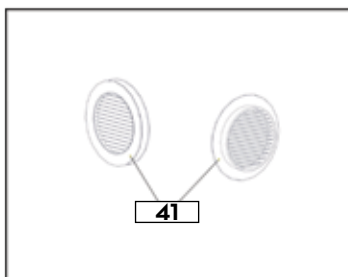
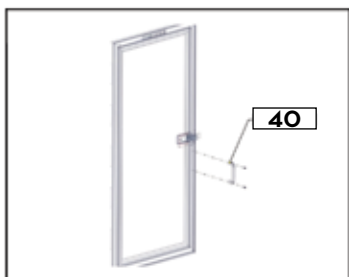

ADA MODULE | MAJOR ASSEMBLY PARTS (CONTINUED)

ITEM #	PART #	QPU	DESCRIPTION	COMMENT
40	SAX-AD-2-0-040		SANITRAX- AD DOOR GRIP INSIDE	
41	SAX-AD-2-0-041		SANITRAX- AD VENTILATION PARTS	
42	SAX-AD-2-0-042		SANITRAX- AD PIPE PVC VAC SYS	
43	SAX-AD-2-0-043		SANITRAX- AD KAMLOCK SET	
44	SAX-AD-2-0-044		SANITRAX- AD CLAM/BOLT VAC SYS	
45	SAX-AD-2-0-045		SANITRAX- AD VAC HOSE W/CLAMP	
46	SAX-AD-2-0-046		SANITRAX- AD WATER PIPING SYS	
47	SAX-AD-2-0-047		SANITRAX- AD CLAM/BOLT PIPE	
48	SAX-AD-2-0-048		SANITRAX- AD TANK WASTEWATR SS	
49	SAX-AD-2-0-049		SANITRAX- AD PARTS VAC VALVE	
50	SAX-AD-2-0-050		SANITRAX- AD SWITCH WATERTK LE	
51	SAX-AD-2-0-051		SANITRAX- AD VAC HOSE 1,30MX63	
52	SAX-AD-2-0-052		SANITRAX- AD HANDRAIL HOOK PRT	
53	SAX-AD-2-0-053		SANITRAX- AD CURTAIN UPPER BCK	
54	SAX-AD-2-0-054		SANITRAX- AD CURTAIN UPPER LOW	
55	SAX-AD-2-0-055		SANITRAX- AD RAMP ENTRY W/PART	
56	SAX-AD-2-0-056		SANITRAX- AD WATER HEATER UL	
57	SAX-AD-2-0-057		SANITRAX- AD WATER HEATER EU	
58	SAX-AD-2-0-058		SANITRAX- AD RAMP SQUARE PART	
59	SAX-AD-2-0-059		SANITRAX- AD RAMP RECTAND PART	
60	SAX-AD-2-0-060		SANITRAX- AD RAMP CONNECT PINS	
61	SAX-AD-2-0-061		SANITRAX- AD RAMP LEVEL FEET	
62	SAX-AD-2-0-062		SANITRAX- AD RAMP RAIL FR LEFT	
63	SAX-AD-2-0-063		SANITRAX- AD RAMP RAIL FR RGHT	
64	SAX-AD-2-0-064		SANITRAX- AD RAMP RAIL BK LEFT	
65	SAX-AD-2-0-065		SANITRAX- AD RAMP RAIL BK RGHT	
66	SAX-AD-2-0-066		SANITRAX- WASTEBIN	
67	SAX-AD-2-0-067		SANITRAX- AD HOLDER PAPER ROLL	
68	SAX-AD-2-0-068		SANITRAX- DOOR RUBBER PROFIL	
69	SAX-AD-2-0-069		SANITRAX- AD STRIP LED	
70	SAX-AD-2-0-070		SANITRAX- PANEL DOOR LIGHT	
71	SAX-AD-2-0-071		SANITRAX- AD RAMP HDWE	

TECH MODULE | MAJOR ASSEMBLY

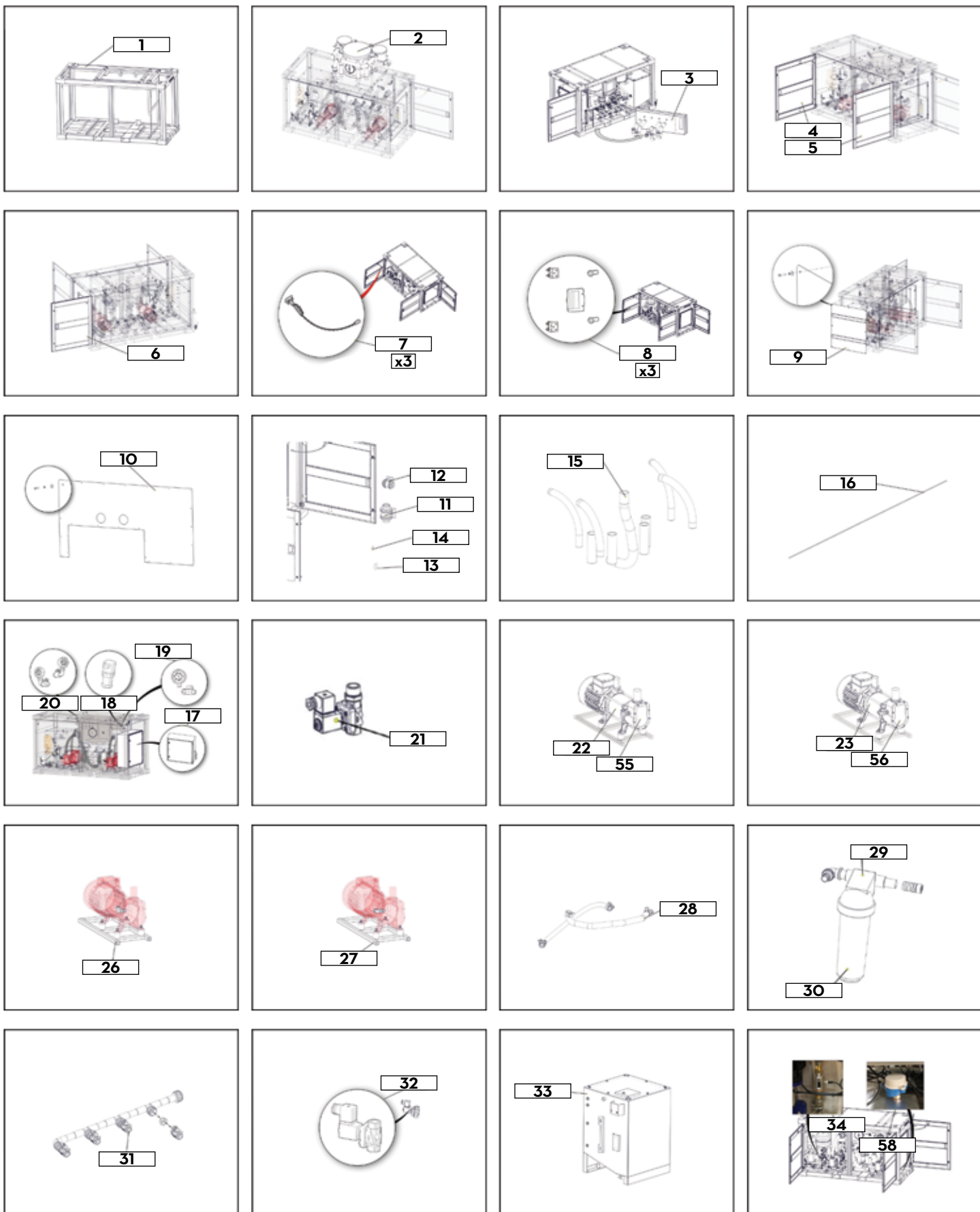

TECH MODULE | MAJOR ASSEMBLY PARTS

ITEM #	PART #	QPU	DESCRIPTION	COMMENT
1	SAX-TM-480V-1-001		SANITRAX- 480V FRAME	
2	SAX-TM-480V-1-002		SANITRAX- 480V MANIFOLD	
3	SAX-TM-480V-1-003		SANITRAX- 480V HOSE CONECTN PL	
4	SAX-TM-480V-1-004		SANITRAX- 480V DOOR L/SID LEFT	
5	SAX-TM-480V-1-005		SANITRAX- 480V DOOR L/Sd RIGHT	
6	SAX-TM-480V-1-006		SANITRAX- 480V DOOR SIDE LK/HG	
7	SAX-TM-480V-1-007		SANITRAX- 480V DOOR CHAIN ST/3	
8	SAX-TM-480V-1-008		SANITRAX- 480V HINGE DOOR ST/3	
9	SAX-TM-480V-1-009		SANITRAX- 480V PANEL SIDE W/Sc	
10	SAX-TM-480V-1-010		SANITRAX- 480V PANEL BACK W/Sc	
11	SAX-TM-480V-1-011		SANITRAX- 480V VALVE 3IN PVC	
12	SAX-TM-480V-1-012		SANITRAX- 480V VALVE 2IN PVC	
13	SAX-TM-480V-1-013		SANITRAX- 480V O RING VALVE 3"	
14	SAX-TM-480V-1-014		SANITRAX- 480V O RING VALVE 2"	
15	SAX-TM-480V-1-015		SANITRAX- 480V VAC CONN HOSE	
16	SAX-TM-480V-1-016		SANITRAX- 480V STRIP LED	
17	SAX-TM-480V-1-017		SANITRAX- 480V ELECTRIC BOX	
18	SAX-TM-480V-1-018		VACUUM TRANSMITTER	
19	SAX-TM-480V-1-019		SANITRAX- 480V VAC M W/VALVE	
20	SAX-TM-480V-1-020		SANITRAX- 480V PRESSURE W/VALV	
21	SAX-TM-480V-1-021		SANITRAX- 480V VALVE PUMP CLEA	
22	SAX-TM-480V-1-022		JETS EDGE LO1 VACUUMARATORPUMP	
23	SAX-TM-480V-1-023		SANITRAX- 480V PUMP 140 MB	
24	SAX-TM-480V-1-024		SANITRAX- 480V KIT 95 OVERHAUL	
25	SAX-TM-480V-1-025		SANITRAX- 480V KIT 140 OVERHAL	
26	SAX-TM-480V-1-026		SANITRAX- 480V PUMP 95MB SLIDE	
27	SAX-TM-480V-1-027		SANITRAX- 480V PUMP 140 SLIDE	
28	SAX-TM-480V-1-028		SANITRAX- 480V HOSE CONN WATER	
29	SAX-TM-480V-1-029		SANITRAX- 480V FILTER WATER	
30	SAX-TM-480V-1-030		SANITRAX- 480V WATER FILTERCAR	
31	SAX-TM-480V-1-031		SANITRAX- 480V OUTLET WATER	
32	SAX-TM-480V-1-032		SANITRAX- 480V VALVE INLET MAG	
33	SAX-TM-480V-1-033		SANITRAX- 480V TANK WATER BUFF	
34	SAX-TM-480V-1-034		SANITRAX- 480V METER WATER FLW	

TECH MODULE | MAJOR ASSEMBLY (CONTINUED)

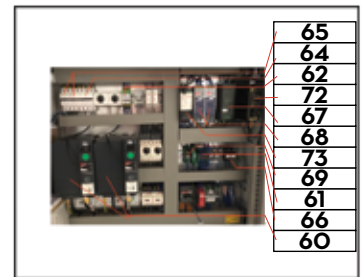
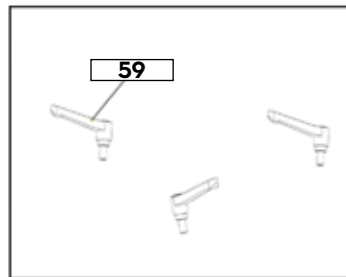
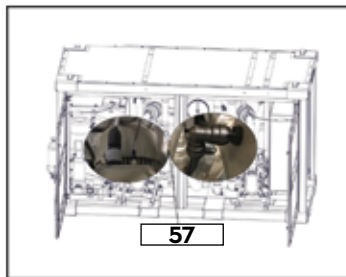
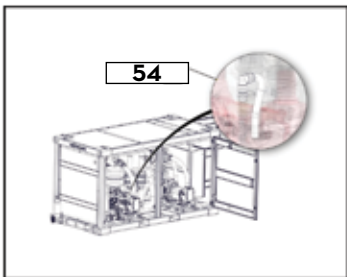
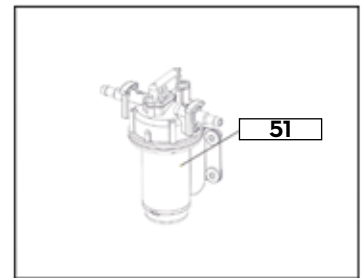
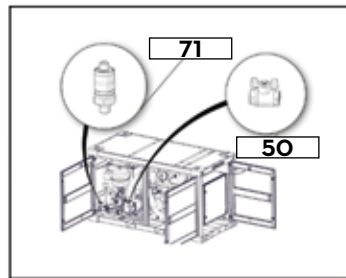
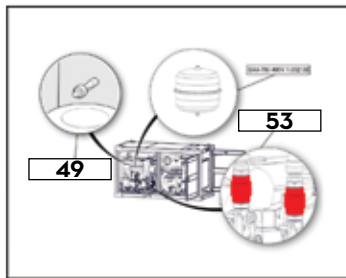
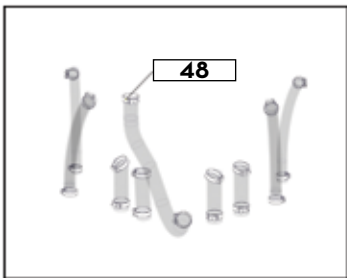
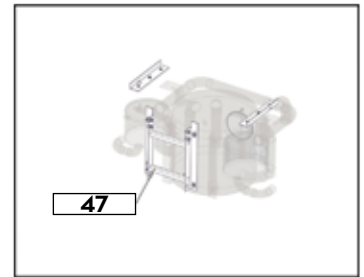
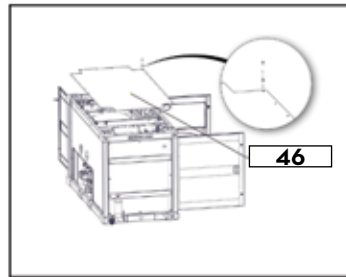
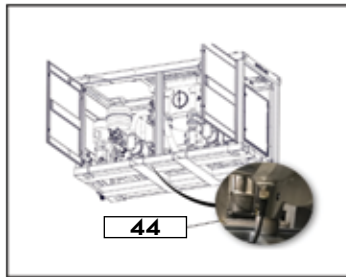
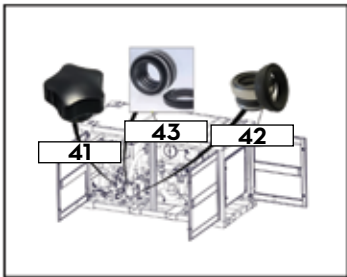
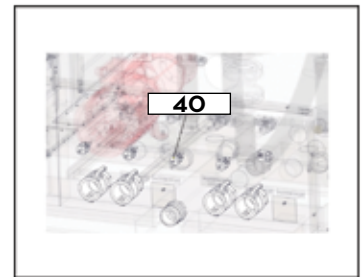
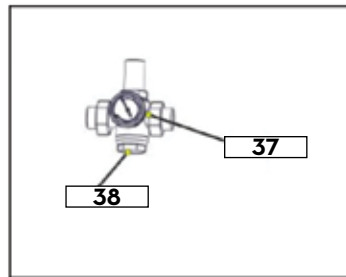
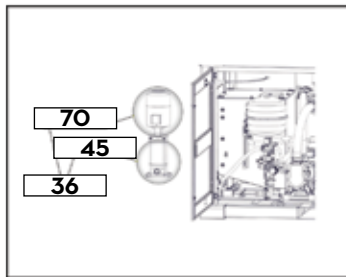
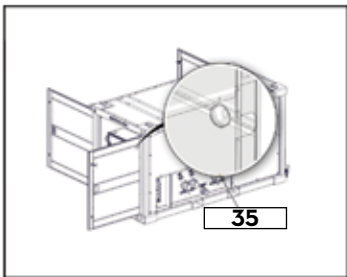

TECH MODULE | MAJOR ASSEMBLY PARTS (CONTINUED)

ITEM #	PART #	QPU	DESCRIPTION	COMMENT
35	SAX-TM-480V-1-035		SANITRAX- 480V ALARM LIGHT	
36	SAX-TM-480V-1-036		SANITRAX- 480V WATER PUMP	
37	SAX-TM-480V-1-037		SANITRAX- VALVE W PRESS REDUCT	
38	SAX-TM-480V-1-038		SANITRAX- 480V VALVE FILTER WT	
39	SAX-TM-480V-1-039		SANITRAX- 480V STICKER SET	
40	SAX-TM-480V-1-040		SANITRAX- 480V KAMLOK SETS	
41	SAX-TM-480V-1-041		SANITRAX- 480V KNOB TANK DOOR	
42	SAX-TM-480V-1-042		SANITRAX- 480V SEAL SHAFT 95M	
43	SAX-TM-480V-1-043		SANITRAX- 480V SEAL SHAFT 140	
44	SAX-TM-480V-1-044		TEMP. SENSOR PT100	
45	SAX-TM-480V-1-045		SANITRAX- 480V PUMP WATER MOTR	
46	SAX-TM-480V-1-046		SANITRAX- 480V P/ROOF RAL 9010	
47	SAX-TM-480V-1-047		SANITRAX- 480V TANK SY HANG SS	
48	SAX-TM-480V-1-048		SANITRAX- 480V HOSE CLAMP ST/3	
49	SAX-TM-480V-1-049		SANITRAX- 480V LEVEL SWITCH	
50	SAX-TM-480V-1-050		SANITRAX- 480V VALVE DRAIN BUF	
51	SAX-TM-480V-1-051		SANITRAX- 480V ANTIFREEZE PUMP	
52	SAX-TM-480V-1-052		SANITRAX- 480V PRESSURE TANK	
53	SAX-TM-480V-1-053		SANITRAX- 480V VALVE NON RETRN	
54	SAX-TM-480V-1-054		SANITRAX- 480V HOSE SET CL/CLN	
55	SAX-TM-480V-1-055		COVER	
56	SAX-TM-480V-1-056		SANITRAX- 480V PUMP 140 MB	
57	SAX-TM-480V-1-057		SANITRAX- THERMO AND FLUSH SET	
58	SAX-TM-480V-1-058		SANITRAX- 480V SENSOR OUT TEMP	
59	SAX-TM-480V-1-059		SANITRAX- 480V PUMPSLID HANDLE	
60	SAX-TM-480V-1-060		SANITRAX- 480V F/CONTR 380-500	
61	SAX-TM-480V-1-061		SANITRAX- 480V CONTROLLER	
62	SAX-TM-480V-1-062		SANITRAX- 480V SWITCH CONTROL	
63	SAX-TM-480V-1-063		SANITRAX- 480V FUSE B 60A/600V	
64	SAX-TM-480V-1-064		SANITRAX- 480V 3 POLE SCH 160N	
65	SAX-TM-480V-1-065		SANITRAX- 480V 2 POLE SCH 160N	
66	SAX-TM-480V-1-066		SANITRAX- 480V FUSE 3,15A 250	
67	SAX-TM-480V-1-067		SANITRAX- 480V PWR SUP 24V/10A	
68	SAX-TM-480V-1-068		SANITRAX- 480V PWR SUP 12V/10A	
69	SAX-TM-480V-1-069		SANITRAX- 480V 2XUTP DATA CON	
70	SAX-TM-480V-1-070		SANITRAX- 480V PUMP WATER 230V	
71	SAX-TM-480V-1-071		SANITRAX- 480V WATER PRESS SEN	
72	SAX-TM-480V-1-072		SANITRAX- 480V MODEM	
73	SAX-TM-480V-1-073		SANITRAX- 480V WATER BOST CONT	
74	SAX-TM-480V-1-074		SANITRAX- 480V WATER FILTER	
75	SAX-TM-480V-1-075		SANITRAX- 480V FILTER CARTRIDG	

HOSE CRATE | MAJOR ASSEMBLY

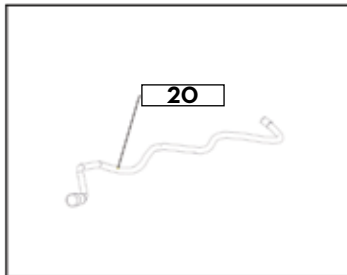
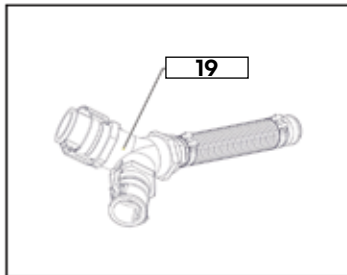
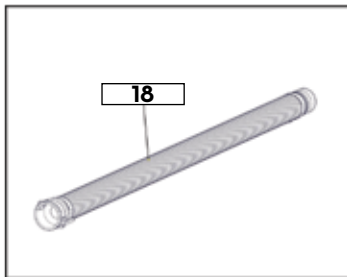
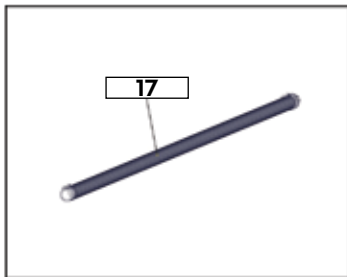
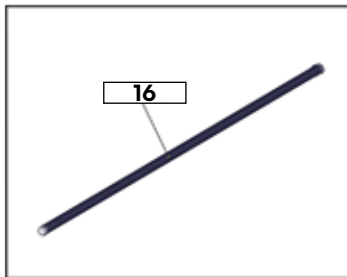
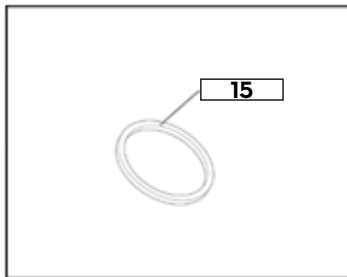
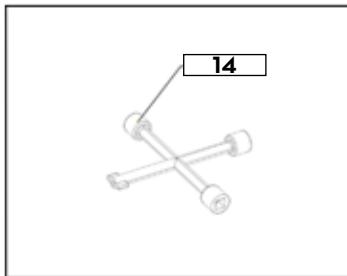
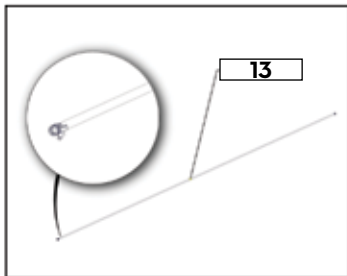
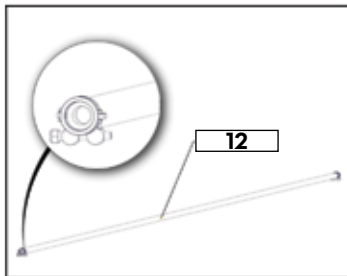
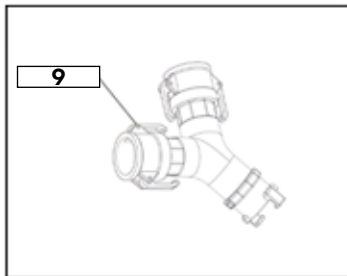
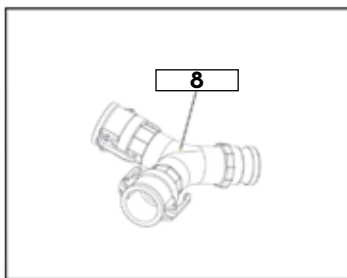
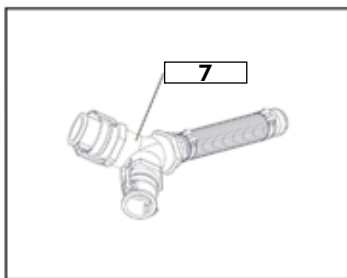
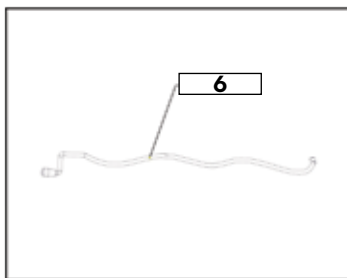
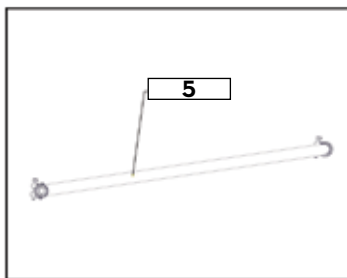
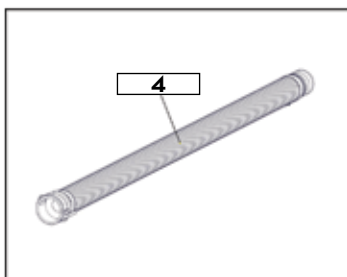
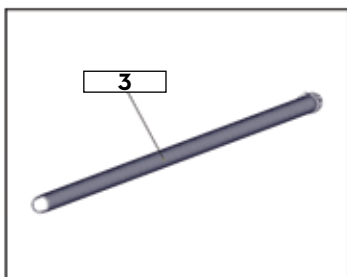
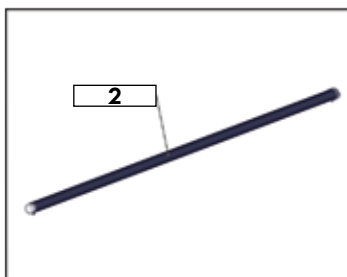
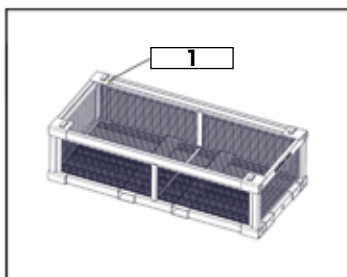

HOSE CRATE | MAJOR ASSEMBLY PARTS

ITEM #	PART #	QPU	DESCRIPTION	COMMENT
1	SAX-HC-001		SANITRAX- HC HOSE CRATE	
2	SAX-HC-002		SANITRAX- HC VAC HOSE 10MX63MM	
3	SAX-HC-003		SANITRAX- HC VAC HOSE 5MX63MM	
4	SAX-HC-004		SANITRAX- HC VAC HOS 1.6MX63MM	
5	SAX-HC-005		SANITRAX- HC WATER HOSE 10MX19	
6	SAX-HC-006		SANITRAX- HC CABLE POWER 12V	
7	SAX-HC-007		SANITRAX- HC URINAL CON HOSE Y	
8	SAX-HC-008		SANITRAX- HC WATER T CON 2X3/4	
9	SAX-HC-009		SANITRAX- T CONN 2X3/4 FMLE SS	
10	SAX-HC-010		SANITRAX- 12 POWER CONVERT 60W	
11	SAX-HC-011		SANITRAX- POWER CONV 110V 60W	
12	SAX-HC-012		SANITRAX- WATER HOSE 15MX19MM	
13	SAX-HC-013		SANITRAX- WATER HOSE 20MX19MM	
14	SAX-HC-014		SANITRAX- KEY MULTI DOOR/E/BOX	
15	SAX-HC-015		SANITRAX- HC KAMLOCK RUB O-RNG	
16	SAX-HC-016		SANITRAX- HOSE EDPM 10MX63MM	
17	SAX-HC-017		SANITRAX- HOSE EDPM 5MX63MM	
18	SAX-HC-018		SANITRAX- HOSE EDPM 1,60MX63MM	
19	SAX-HC-019		SANITRAX- HC Ur CON Hos Y EDPM	
20	SAX-HC-020		SANITRAX- HR CABLE PWR 12V 1 M	
21	SAX-HC-021		SANITRAX- HC ADAPTER CABLE 12V	